



Make Your Dream Kitchen Come True

Quality Framed Kitchen Cabinets

Table of Contents



-About Us-----	Page 2
-Our Vision & Mission-----	Page 3
-Product Showcase-----	Page 4-9
-Products Information-----	Page 10-54
-Our Commitment to sustainability & Environmental Responsibility-----	Page 55
-Limited Liability Warranty-----	Page 56-57
-Kitchen Cabinets Maintenance Guidelines-----	Page 58-59
-FERMA Cabinetry Samples Display Program-----	Page 60-61
-New Account Application Form-----	Page 62-63
-Order Form-----	Page 64-71

About FERMA CABINETRY

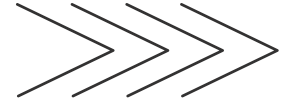

 FERMA CABINETRY is kitchen cabinetry manufacturer and distributor located at Edison, New Jersey. It is a trusted brand expanded from FERMA FLOORING, a company carrying out and distributing nationwide variety of flooring, such as hardwood flooring, luxury vinyl flooring and laminate flooring with over 23 years of experience in the flooring industry and a strong reputation for quality, reliability and customer service since the year 2002. Building on its success in flooring, FERMA FLOORING has expanded into the kitchen cabinetry business with the same commitment to excellence under the name of FERMA CABINETRY.

FERMA CABINETRY provides premium kitchen cabinets, meticulously designed to meet the unique needs of homeowners, contractors, and designers. Combining enduring durability, intuitive functionality, and contemporary aesthetics,

FERMA CABINETRY solutions transform kitchens into spaces of beauty and practical efficiency.

Why Choose FERMA CABINETRY?

Premium Quality Materials – FERMA CABINETRY uses high-grade solid wood and superior craftsmanship to ensure long-lasting performance.

Elegant & Versatile Designs – FERMA CABINETRY offers a variety of styles, finishes, and colors to complement different kitchen aesthetics, from classic to modern.

Affordability & Value – FERMA CABINETRY provides cost-effective cabinetry without compromising on quality, making beautiful kitchens accessible to more end users.

Durability & Functionality – FERMA CABINETRY designs its cabinetry with durability and convenience with user-friendly features like soft-close drawers, spacious storage, and durable hinges.

Trusted Brand Backed By Experience – With FERMA FLOORING'S long standing industry and customer service's expertise, customers can trust the same level of excellence in FERMA CABINETRY.

FERMA CABINETRY is committed to bringing customers exceptional cabinetry solutions that enhance both the functionality and elegance of their kitchens. Whether remodeling or designing a new space, FERMA CABINETRY delivers high-quality, stylish, and affordable options to bring your vision to life.

OUR VISION & MISSION

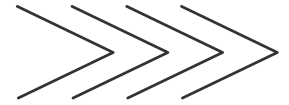

At FERMA CABINETRY, we will dedicate ourselves to delivering exceptional cabinetry solutions that seamlessly blend functionality and elegance to every kitchen. Whether you're remodeling a cherished space or crafting a new one from scratch, we offer stylish, high-quality cabinetry at accessible prices—luxury and affordability can coexist. Our commitment to craftsmanship ensures your vision is transformed into a kitchen that inspires daily life.

- **Craftsmanship Excellence:** Providing meticulously crafted cabinetry using high-quality materials and innovative techniques.
- **Customer Satisfaction:** Ensuring customers to receive the best service.
- **Innovation & Design:** Continuously improving our designs, materials, and manufacturing processes to meet modern kitchen trends and customer needs.



Quality Framed Kitchen Cabinets



White Shaker
Manhattan (MH)



Gray Shaker
SoHo (SH)



Birch Natural Slim Shaker
Cortado (CO)



Off White Slim Shaker
Mastic (MC)



Oak Natural Slim Shaker
Sandy Shore (SS)

White Shaker MANHATTAN (MH)

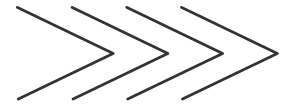

Wall Cabinet Height: 30 "36 " &39"

Door Material: Solid wood birch door frames with 1/2" thick MDF center panel

Door Style: Full overlay framed doors with painted UV cured finish with reverse raised center panel

Hinges: 6-way adjustable & soft close hinges.

Box Front Frame Material: Solid wood.

Box Material: 1/2" thick selected plywood with matching finish interior & exterior.

Box Thickness: 1/2"

Box Construction: Dado joint with metal cam lock system and wood corner braces for extra support.

Box Finish: All boxes have matching finish interior and exterior.

Drawer Box: 5/8" thick solid wood box with dovetail joint construction, and natural finish with full extension concealed drawer runners.

Drawer Front: 5-pieces finished and recessed panel drawer fronts.

Drawer Glides & Locks: Undermount drawer locks & undermount full extension glides with soft closing

Shelves: 3/4" plywood full depth finished with PVC edge banded on front and supported by metal pins.

Compliance: All Plywood and MDF are CARB-2 compliant.

Glass door is made of tempered glass.

Gray Shaker SoHo (SH)



- Wall Cabinet Height:** 30" & 39"
- Door Material:** Solid birch wood door frames with 1/2" thick MDF center panel.
- Door Style:** Full overlay framed doors with painted UV cured finish with reverse raised center panel
- Hinges:** 6-way adjustable & soft close hinges.
- Box Front Frame Material:** Solid wood.
- Box Material:** 1/2" thick selected plywood with matching finish interior & exterior.
- Box Thickness:** 1/2"
- Box Construction:** Dado joint with metal cam lock system and wood corner braces for extra support.
- Box Finish:** All boxes have matching finish interior and exterior.
- Drawer Box:** 5/8" thick solid wood box with dovetail joint construction, and natural finish with full extension concealed drawer runners.
- Drawer Front:** 5-pieces finished and recessed panel drawer fronts.
- Drawer Glides & Locks:** Undermount drawer locks & undermount full extension glides with soft closing
- Shelves:** 3/4" plywood full depth finished with PVC edge banded on front and supported by metal pins.
- Compliance:** All Plywood and MDF are CARB-2 compliant.
Glass door is made of tempered glass.

Birch Natural Slim Shaker Cortado (CO)



- Wall Cabinet Height: 30" 36 " & 42"
Door Material: ¾" solid birch wood door frames with 5/8" thick three-layers plywood center panel.
Door Style: Full overlay framed doors with UV cured finish & recessed flat center panel.
Hinges: 6-way adjustable & soft closing.
Box Front Frame Material: Solid wood (1-1/2" wide x ¾" thick)
Box Material: 1/2" thick plywood with natural wood veneer finished interior & exterior.
Box Thickness: 1/2"
Box Construction: Dado joint glued & nailed.
Bottom of Base Cabinet: Additional 4-piece wood supports.
Top of Base Cabinet: 4 Corner wood braces for extra support.
Back of Base Cabinet: ½" thick 1-piece plywood.
Box Finish: All boxes have natural wood veneer finished interior & exterior, and additional decorative & self-sticking side panels with matching color are also available
Drawer Box: 5/8" thick solid wood box with dovetail joint construction, and natural finish with full extension concealed drawer runners.
Drawer Front: 5-pieces finished with recessed panel drawer fronts.
Drawer Glides & Locks: Undermount drawer locks & undermount full extension glides with soft closing
Shelves: 3/4" plywood full depth finished with PVC edge banded on front and supported by metal pins.
Compliance: All Plywood and MDF are CARB-2 compliant.
Glass door is made of tempered glass.

Off White Slim Shaker Mastic (MC)



- Wall Cabinet Height: 30" 36" & 42"
- Door Material: ¾" MDF door frames with 5/8" thick three-layers plywood center panel.
- Door Style: Full overlay framed doors with painted UV cured finish & recessed flat center panel.
- Hinges: 6-way adjustable & soft closing.
- Box Front Frame Material: Solid wood (1-1/2" wide x ¾" thick)
- Box Material: 1/2" thick plywood with natural wood veneer finished interior & exterior.
- Box Thickness: 1/2"
- Box Construction: Dado joint glued & nailed.
- Bottom of Base Cabinet: Additional 4-piece wood supports.
- Top of Base Cabinet: 4 Corner wood braces for extra support.
- Back of Base Cabinet: ½" thick 1-piece plywood.
- :Box Finish: All boxes have natural wood veneer finished interior & exterior, and additional decorative & self-sticking side panels with matching color are also available
- Drawer Box: 5/8" thick solid wood box with dovetail joint construction, and natural finish with full extension concealed drawer runners.
- Drawer Front: 5-pieces finished with recessed panel drawer fronts.
- Drawer Glides & Locks: Undermount drawer locks & undermount full extension glides with soft closing
- Shelves: 3/4" plywood full depth finished with PVC edge banded on front and supported by metal pins.
- Compliance: All Plywood and MDF are CARB-2 compliant.
Glass door is made of tempered glass.

Oak Natural Slim Shaker Sandy Shore (SS)



- Wall Cabinet Height: 30" 36" & 42"
Door Material: ¾" solid oak wood door frames with 5/8" thick three-layers plywood center panel.
Door Style: Full overlay framed doors with UV cured finish & recessed flat center panel.
Hinges: 6-way adjustable & soft closing.
Box Front Frame Material: Solid wood (1-1/2" wide x ¾" thick)
Box Material: 1/2" thick plywood with natural wood veneer finished interior & exterior.
Box Thickness: 1/2"
Box Construction: Dado joint glued & nailed.
Bottom of Base Cabinet: Additional 4-piece wood supports.
Top of Base Cabinet: 4 Corner wood braces for extra support.
Back of Base Cabinet: ½" thick 1-piece plywood.
Box Finish: All boxes have natural wood veneer finished interior & exterior, and additional decorative & self-sticking side panels with matching color are also available
Drawer Box: 5/8" thick solid wood box with dovetail joint construction, and natural finish with full extension concealed drawer runners.
Drawer Front: 5-pieces finished with recessed panel drawer fronts.
Drawer Glides & Locks: Undermount drawer locks & undermount full extension glides with soft closing
Shelves: 3/4" plywood full depth finished with PVC edge banded on front and supported by metal pins.
Compliance: All Plywood and MDF are CARB-2 compliant.
Glass door is made of tempered glass.



Products Information - SH / MH

CABINET SPECIFICATIONS	
Wall Cabinet Height:	30 "36 " & 39" (Manhattan: 30& "36 "39" SoHo: 30& "39")
Door Material:	Solid wood door frames with 1/2" thick MDF center panel.
Door Style:	Full overlay framed doors with painted UV cured finish with reverse recess center panel
Hinges:	6-way adjustable & soft close hinges.
Box Front Frame Material:	Solid wood.
Box Material:	1/2" thick selected plywood with matching finish interior & exterior.
Box Thickness:	1/2"
Box Construction:	Dado joint with metal cam lock system and wood corner braces for extra support.
Box Finish:	All boxes have matching finish interior and exterior.
Drawer Box:	5/8" thick solid wood box with dovetail joint construction, and natural finish with full extension concealed drawer runners.
Drawer Front:	5-pieces finished and recessed panel drawer fronts.
Drawer Glides & Locks:	Undermount drawer locks & undermount full extension glides with soft closing
Shelves:	3/4" plywood full depth finished with PVC edge banded on front and supported by metal pins.
Compliance:	All Plywood and MDF are CARB-2 compliant. Glass door is made of tempered glass.

CABINET CONSTRUCTION SHOWCASE

- ① Box: Dovetail construction with 1/2" thick selected plywood & matching finishes interior and exterior
- ② Box: Dado joint and metal cam lock system and wood corner braces for extra support.
- ③ Drawer: 5-pieces recessed panel drawer fronts with dovetail jointed 5/8" thick solid wood boxes.
- ④ Glides: Undermount & full extension soft closing.
- ⑤ Door: Solid wood door frames with 1/2" thick MDF center panel
- ⑥ Shelves: 3/4" plywood full depth finished supported by metal pins.
- ⑦ Hinges: 6-way adjustable soft closing.



Products Information - MC

CABINET SPECIFICATIONS	
Wall Cabinet Height:	30" 36 " & 42"
Door Material:	¾" MDF door frames with 5/8" thick three-layers plywood center panel.
Door Style:	Full overlay framed doors with painted UV cured finish & recessed flat center panel.
Hinges:	6-way adjustable & soft closing.
Box Front Frame Material:	Solid wood (1-1/2" wide x ¾" thick)
Box Material:	1/2" thick plywood with natural wood veneer finished interior & exterior.
Box Thickness:	1/2"
Box Construction:	Dado joint glued & nailed.
Bottom of Base Cabinet:	Additional 4-piece wood supports.
Top of Base Cabinet:	4 Corner wood braces for extra support.
Back of Base Cabinet:	½" thick 1-piece plywood.
:Box Finish:	All boxes have natural wood veneer finished interior & exterior, and additional decorative & self-sticking side panels with matching color are also available
Drawer Box:	5/8" thick solid wood box with dovetail joint construction, and natural finish with full extension concealed drawer runners.
Drawer Front:	5-pieces finished with recessed panel drawer fronts.
Drawer Glides & Locks:	Undermount drawer locks & undermount full extension glides with soft closing
Shelves:	¾" plywood full depth finished with PVC edge banded on front and supported by metal pins.
Compliance:	All Plywood and MDF are CARB-2 compliant. Glass door is made of tempered glass.

CABINET CONSTRUCTION SHOWCASE	
<p>① Box: 1/2" thick selected plywood & natural wood veneer finished interior</p> <p>② Box: Dado joint glued & nailed construction and wood corner braces for extra support.</p> <p>③ Drawer: 5-pieces recessed panel drawer fronts with dovetail jointed 5/8" thick solid wood boxes.</p> <p>④ Glides: Undermount & full extension soft closing.</p> <p>⑤ Door: MDF door frames with 5/8" thick three-layers plywood center panel</p> <p>⑥ Shelves: ¾" plywood full depth finished supported by metal pins.</p> <p>⑦ Hinges: 6-way adjustable soft closing.</p> <p>⑧ Additional decorative & self-sticking side panels with matching finish are available.</p>	 <p>Carb2 compliant</p>

Products Information - CO / SS

CABINET SPECIFICATIONS	
Wall Cabinet Height:	30" 36 " &42"
Door Material:	¾" solid wood door frames with 5/8" thick three-layers plywood center panel.
Door Style:	Full overlay framed doors with painted UV cured finish & recessed flat center panel.
Hinges:	6-way adjustable & soft closing.
Box Front Frame Material:	Solid wood (1-1/2" wide x ¾" thick)
Box Material:	1/2" thick plywood with natural wood veneer finished interior & exterior.
Box Thickness:	1/2"
Box Construction:	Dado joint glued & nailed.
Bottom of Base Cabinet:	Additional 4-piece wood supports.
Top of Base Cabinet:	4 Corner wood braces for extra support.
Back of Base Cabinet:	½" thick 1-piece plywood.
Box Finish:	All boxes have natural wood veneer finished interior & exterior, and additional decorative & self-sticking side panels with matching color are also available
Drawer Box:	5/8" thick solid wood box with dovetail joint construction, and natural finish with full extension concealed drawer runners.
Drawer Front:	5-pieces finished with recessed panel drawer fronts.
Drawer Glides & Locks:	Undermount drawer locks & undermount full extension glides with soft closing
Shelves:	¾" plywood full depth finished with PVC edge banded on front and supported by metal pins.
Compliance:	All Plywood and MDF are CARB-2 compliant. Glass door is made of tempered glass.

CABINET CONSTRUCTION SHOWCASE	
<p>①Box: 1/2" thick selected plywood & natural wood veneer finished interior</p> <p>② Box: Dado joint glued & nailed construction and wood corner braces for extra support.</p> <p>③ Drawer: 5-pieces recessed panel drawer fronts with dovetail jointed 5/8" thick solid wood boxes.</p> <p>④ Glides: Undermount & full extension soft closing.</p> <p>⑤ Door: MDF door frames with 5/8" thick three-layers plywood center panel</p> <p>⑥ Shelves: ¾" plywood full depth finished supported by metal pins.</p> <p>⑦ Hinges: 6-way adjustable soft closing.</p> <p>⑧ Additional decorative & self-sticking side panels with matching finish are available.</p>	 <p>Carb2 compliant</p>

SHAKER STYLE (SH/MH)-DETAILS OF CONSTRUCTION



Full overlay framed doors with painted UV cured finish with reverse recess center panel



Back of Base Cabinet:
1/5" + 1/2" thick plywood



1/2" thick selected plywood with finish of matching color interior & exterior.



5/8" thick solid wood box with dovetail joint construction, and natural finish with full extension concealed drawer runners.



Dado joint with metal-cam lock construction and wood corner braces for extra support



6-way adjustable & soft closing hinges



3/4" plywood full depth finished shelves with PVC edge banded on front and supported by metal pins



Undermount full extension with soft closing

SLIM SHAKER (MC/CO/SS)-DETAILS OF CONSTRUCTION



5/8" thick solid wood drawer box with dovetail joint construction, and natural finish with full extension concealed drawer runners.



5/8" thick three-layers plywood center panel with solid wood core



Dado joint glued & nailed construction and wood corner braces for extra support



Glass door cabinet with matching colors interiorly finished



Undermount full extension with soft closing



Lazy Susan Insert



Back of Base Cabinet:
1/2" thick full piece of plywood



Spice Rack Pull Out



3/4" plywood full depth shelves with natural birch wood veneer finished and supported by metal pins.



Drawer base cabinet with three Drawers

General Policy



A. DELIVERY CHARGES

1. For Assembled Cabinets

To store/warehouse: 6% of the invoice amount. Minimum charge is \$149.00 and Maximum charge is \$199.00
To job site, additional: \$75.00 (garage delivery only).

Special Promotion for Delivery: \$99.00 to store, warehouse & \$129.00 to job site (curb site only) within a 100-miles radius from FERMA DISTRIBUTION WAREHOUSE at 83 Mayfield Ave, Edison, New Jersey 08837. It is effective now until June 30, 2025.

2. For Unassembled Cabinets (Flat Pack)

To store/warehouse/job site (curb site only): \$99.00

Above rate is only applied to deliveries located within a 100-miles radius from the FERMA distribution warehouse. For other shipping rates outside of this area, please call for freight rates quotation.

B. LEAD TIME

5-10 working (business) days from date of order confirmation:

ORDER INSTRUCTION



A. TO PLACE AN ORDER

1. Orders may be placed using the order forms provided by FERMA CABINETRY.
2. All pages must be properly filled in when the orders are placed.
3. Specify shipping method (delivery or pick up), purchase order number and requested ship date.
Assembled orders are normally ready to be shipped or picked up within 5-10 days of order confirmation.
4. If the order is to ship to a job site, then it must be noted as so along with a telephone number and contact person. Additional charges may apply.
5. FERMA CABINETRY schedules orders on a first-in-first-out basis, according to your requested shipping schedule. If you foresee that you will have more than one order, it would be best to batch your orders and then send them in at one time.
6. Rush orders may incur additional charges.
7. Pricing does not include freight. Contact your customer service representative for freight pricing for your area.
8. Please allow additional business days for completion of orders made with custom options and/or modifications.
9. Orders not picked up after four weeks will be stored at the dealers' expense

B. ORDER PROCESSING

1. FERMA CABINETRY will e-mail or fax an Order Confirmation you. If you do not receive an Order Confirmation within 6 hours of order placement, please contact us.
2. Customers are responsible for order accuracy and should sign an email or fax the Order Confirmation back to FERMA CABINETRY. Orders will not be processed until a signed Order Confirmation is received.

C. SHIPPING SHORTAGES & DAMAGES

Order shortages such as missing items and/or any visible shipping damages must be noted on the shipping receipt and signed by both the driver and the recipient. It is the customer's responsibility to notify FERMA CABINETRY of any such issues within 24 hours of accepting the delivery. Any orders accepted and signed by the customer without any such note will be considered complete. All other shipping damages must be claimed by the customer within 5 days. All items that have been installed and/or are not in their original packaging cannot be claimed damaged.

Terms and Condition of Sale



1. The sales order WILL NOT be processed until it is signed and received by FERMA CABINETRY. The customer's signature on the sales order indicates that the order information is accurate and confirmed and approved by the customer for intended purchase/shipment. If the customer makes revisions, a signature is required on the revised order confirmation. Until it is confirmed and approved with the customer's signature, the sales order is to be treated as a quotation ONLY, which does not hold inventory at all, and the items quoted may be unavailable after it. FERMA CABINETRY reserves the right to cancel, modify, or refuse any confirmed orders for any reason, with notice. FERMA CABINETRY is not responsible for any failed fax or emailed transmissions/transcription errors.
2. Any payment, acceptance of goods, and/or signature for the sales order indicates acceptance of all current warranties and policies and the terms and conditions set forth herein by FERMA CABINETRY
3. The customer fully understands and agrees that after the sales order is confirmed and approved by its signature, all possible return, changes or exchange, and cancellations (it is allowed within 30 days only, and the returned products must be in un-opened and resalable condition) would be subjected to 25% restocking fee; However, Any assembled, discounted, bulk sale, and display, or discontinued items CAN NOT be returned and is not refundable. Any damaged goods can be returned under the standard return policy for replacement. If shipped via a common carrier, any damage claim must be submitted to the carrier. Pick up, via freight, and pick up via ground orders are considered a transfer of possession within the state of New Jersey.
4. If returns/ cancellations are accepted, all payment made for this sales order could be refunded, with deducting any restocking fee, but it is for store credit ONLY. The customer is responsible for return shipping if the return is not due to the fault of FERMA CABINETRY.
5. The sales order must be confirmed and approved by the customer signature and submitted to FERMA CABINETRY. Any returned check service fee is to be \$50.00. Any order held past its original scheduled shipping date would be subjected to a storage fee of \$35.00/day for additional storage, and the order would be cancelled after 45 days, and all payment made for this order is NOT refundable.
6. The freight quoted for the sales order is based on estimated weight and freight quote by the carrier on date of quotation, and it may not reflect actual freight charged by the carrier on pick up date. The customer is to be responsible for any and all variations in freight, including refusal of goods, storage or missed delivery charges by carrier.

Wall Cabinet 42" (Single Door)

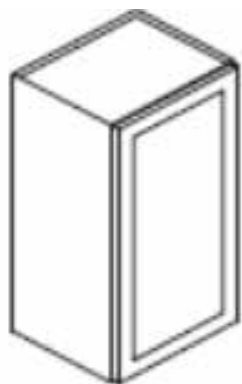

ITEM #	WIDTH	SPECS	
		HEIGHT	DEPTH
W0942	9	42	12
W1242	12	42	12
W1542	15	42	12
W1842	18	42	12
W2142	21	42	12

Wall Cabinet 42" (Double Door)

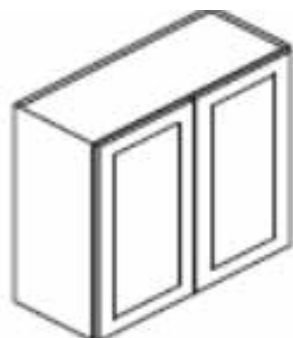

ITEM #	WIDTH	HEIGHT	SPECS	
			DEPTH	MH&SH
W2442	24	42	12	N/A
W2742	27	42	12	N/A
W3042	30	42	12	N/A
W3342	33	42	12	N/A
W3642	36	42	12	N/A

Wall Cabinet 39" (Single Door)

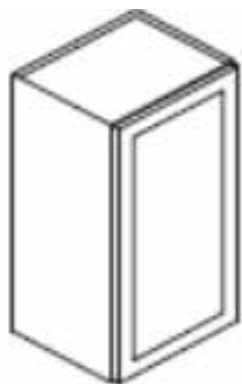

ITEM #	WIDTH	SPECS	
		HEIGHT	DEPTH
W0939	9	39	12
W1239	12	39	12
W1539	15	39	12
W1839	18	39	12
W2139	21	39	12

Wall Cabinet 39" (Double Door)

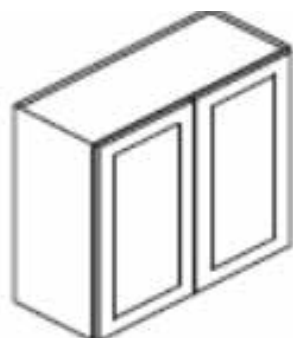

ITEM #	WIDTH	SPECS	
		HEIGHT	DEPTH
W2439	9	39	12
W2739	12	39	12
W3039	15	39	12
W3339	18	39	12
W3639	21	39	12

Wall Cabinet 36" (Single Door)

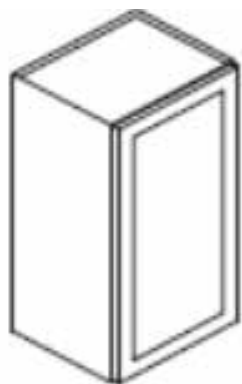

ITEM #	WIDTH	SPECS	
		HEIGHT	DEPTH
W0936	9	36	12
W1236	12	36	12
W1536	15	36	12
W1836	18	36	12
W2136	21	36	12

Wall Cabinet 36" (Double Door)

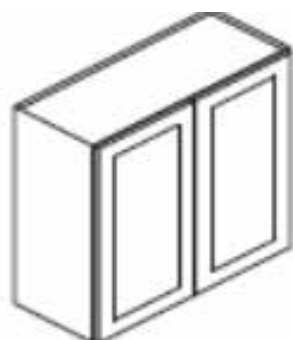

ITEM #	WIDTH	SPECS	
		HEIGHT	DEPTH
W2436	24	36	12
W2736	27	36	12
W3036	30	36	12
W3336	33	36	12
W3636	36	36	12

Please note: SoHo Gray is not available in 36" Height Wall cabinet

Wall Cabinet 30" (Single Door)

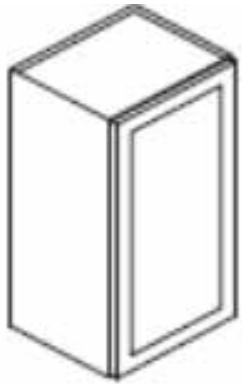

ITEM #	WIDTH	SPECS	
		HEIGHT	DEPTH
W0930	9	30	12
W1230	12	30	12
W1530	15	30	12
W1830	18	30	12
W2130	21	30	12

Wall Cabinet 30" (Double Door)

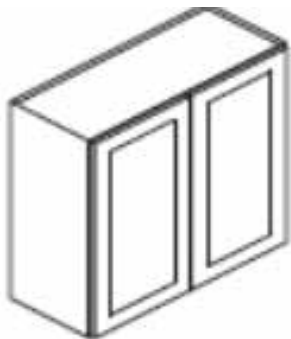

ITEM #	WIDTH	SPECS	
		HEIGHT	DEPTH
W2430	24	30	12
W2730	27	30	12
W3030	30	30	12
W3330	33	30	12
W3630	36	30	12

Wall Cabinet 24" (Double Door)

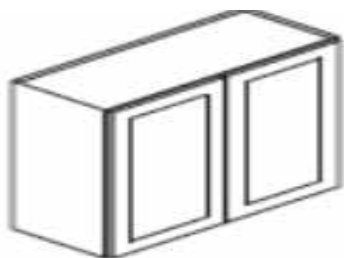

ITEM #	WIDTH	SPECS	
		HEIGHT	DEPTH
W2424	24	24	12
W3024	30	24	12
W3324	33	24	12
W3624	36	24	12
W362424	36	24	24

Wall Cabinet 21" (Double Door)

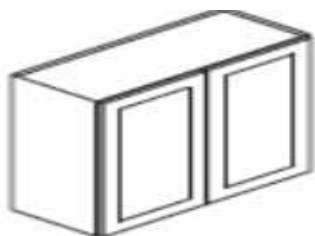

ITEM #	WIDTH	SPECS	
		HEIGHT	DEPTH
W2421	24	21	12
W3021	30	21	12
W302124	30	21	24
W3621	36	21	12
W362124	36	21	24

Wall Cabinet 18" (Double Door)

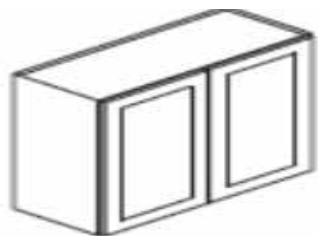

ITEM #	WIDTH	SPECS	
		HEIGHT	DEPTH
W2418	24"	18"	12"
W3018	30	18	12
W301824	30	18	24
W3318	33	18	12
W331824	33	18	24
W3321	33	21	12
W332124	33	21	24
W3618	36	18	12
W361824	36	18	24

Wall Cabinet 15" (Double Door)

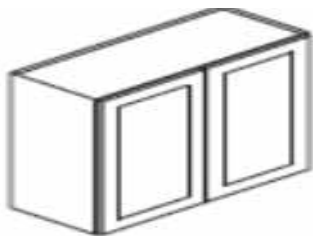

ITEM #	WIDTH	SPECS	
		HEIGHT	DEPTH
W2415	24	15	12
W3015	30	15	12
W301524	30	15	24
W3315	33	15	12
W331524	33	15	24
W3615	36	15	12
W361524	36	15	24

Wall Cabinet 12" (Double Door)

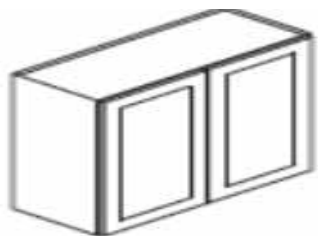

ITEM #	WIDTH	SPECS	
		HEIGHT	DEPTH
W3012	30	12	12
W301224	30	12	24
W3312	33	12	12
W3612	36	12	12
W361224	36	12	24

*Please note: Items with * are not in stock yet, coming soon

Blind Wall Cabinet



ITEM #	WIDTH	SPECS	
		HEIGHT	DEPTH
BLW27/3030	27/30	30	12
BLW27/3036	27/30	36	12
BLW27/3039	27/30	39	12
BLW27/3042	27/30	42	12

Wall Diagonal Cabinet



ITEM #	WIDTH	SPECS	
		HEIGHT	DEPTH
WDC2430	24	30	24
WDC2436	24	36	24
WDC2439	24	39	24
WDC2442	24	42	24
WDC273615	27	36	15
WDC273915	27	39	15
WDC274215	27	42	15

WDC 2430 Door Frame:30" Door width with frame:17" Door Height: 29 ¾", Door width:14 ½"

Wall Easy Reach

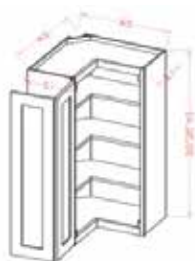

ITEM #	WIDTH	SPECS	
		HEIGHT	DEPTH
WER2430	24	30	12
WER2436	24	36	12
WER2439	24	39	12
WER2442	24	42	12

Wall End Cabinet

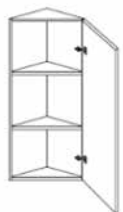

ITEM #	WIDTH	SPECS	
		HEIGHT	DEPTH
WEC1230	12	30	12
WEC1236	12	36	12
WEC1239	12	39	12
WEC1242	12	42	12

Wall End Shelf

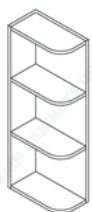

ITEM #	WIDTH	SPECS	
		HEIGHT	DEPTH
WES0630	6	30	12
WES0636	6	36	12
WES0639	6	39	12
WES0642	6	42	12

Please note: SoHo Gray is not available in 36" Height Wall cabinet

Wall Open Shelf



ITEM #	WIDTH	SPECS	
		HEIGHT	DEPTH
WOS3030	30	30	12
WOS3036	30	36	12
WOS3039	30	39	12
WOS3042	30	42	12

Microwave Shelf

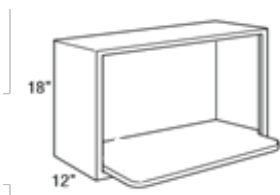

ITEM #	WIDTH	SPECS	
		HEIGHT	DEPTH
MS3018	30	18	12

Wine Rack



ITEM #	WIDTH	SPECS	
		HEIGHT	DEPTH
WR3018	30	18	12
WX1818	18	18	12

Wall Organizer

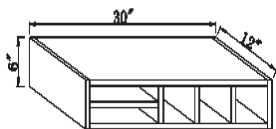

ITEM #	WIDTH	SPECS	
		HEIGHT	DEPTH
WO3006	30	6	12

Wall Counter Drawer

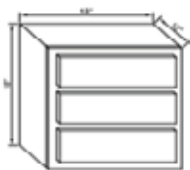

ITEM #	WIDTH	SPECS	
		HEIGHT	DEPTH
WD1818	18	18	12

Base Cabinet (Single Door)

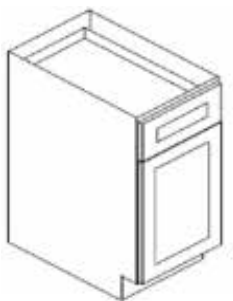

ITEM#	WIDTH	SPECS	
		HEIGHT	DEPTH
B09	9	34 1/2	24
B12	12	34 1/2	24
B15	15	34 1/2	24
B18	18	34 1/2	24
B21	21	34 1/2	24

Base Cabinet (Double Door, Single Drawer)

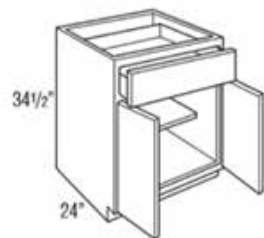

ITEM#	WIDTH	SPECS	
		HEIGHT	DEPTH
B24	24	34 1/2	24
B27	27	34 1/2	24
B30	30	34 1/2	24

Base Cabinet (Double Door, Double Drawer)

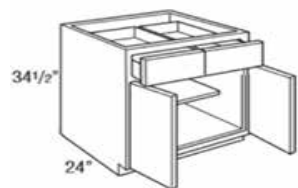

ITEM #	WIDTH	SPECS	
		HEIGHT	DEPTH
B33	33	34 1/2	24
B36	36	34 1/2	24

Drawer Base Cabinet (3 Drawers)

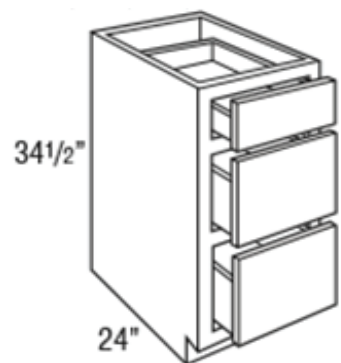

ITEM #	WIDTH	SPECS	
		HEIGHT	DEPTH
DB12-3	12	34 1/2	24
DB15-3	15	34 1/2	24
DB18-3	18	34 1/2	24
DB21-3	21	34 1/2	24
DB24-3	24	34 1/2	24
DB27-3	27	34 1/2	24
DB30-3	30	34 1/2	24
DB33-3 ^(Soho only)	33	34 1/2	24
DB36-3	36	34 1/2	24

*DB33: SoHo available, Manhattan coming soon

Sink Base Cabinet

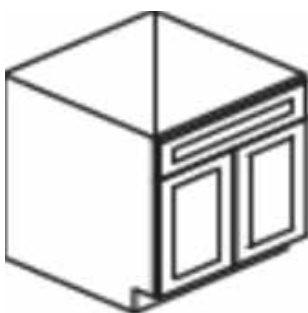

ITEM #	WIDTH	SPECS	
		HEIGHT	DEPTH
SB24	24	34 1/2	24
SB27	27	34 1/2	24
SB30	30	34 1/2	24
SB33	33	34 1/2	24
SB36	36	34 1/2	24

Farm Sink Base Cabinet

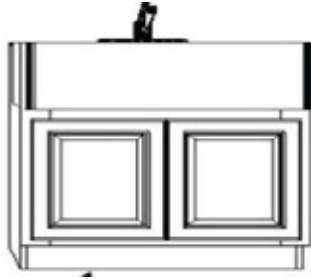

ITEM #	WIDTH	SPECS	
		HEIGHT	DEPTH
FSB30	30	34 ½	24
FSB33	33	34 ½"	24
FSB36	33	34 ½"	24

Corner Sink Base Cabinet

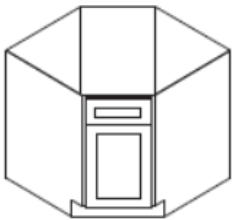

ITEM #	WIDTH	SPECS	
		HEIGHT	DEPTH
CSB36	36	34 1/2	24

Door Height:23" Width: 14 1/2"

Blind Base Cabinet

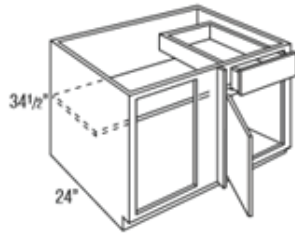

ITEM #	WIDTH	SPECS	
		HEIGHT	DEPTH
BCB36/39	36/39	34 1/2	24
BCB42/45	42/45	34 1/2	24

BCB36/39: Door 11 1/2" Middle Filler:15" BCB42/45: Door: 14 1/2" x 23"

Lazy Susan Base Cabinet

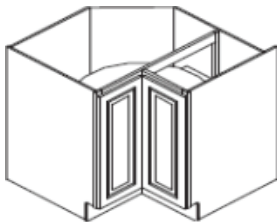

ITEM #	WIDTH	SPECS	
		HEIGHT	DEPTH
LS33	33	34 1/2	24
LS36	36	34 1/2	24

Base Spice Rack Cabinet

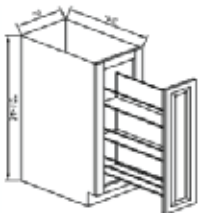

SPECS			
ITEM #	WIDTH	HEIGHT	DEPTH
SP09	09	34 1/2	24

Base Microwave Cabinet

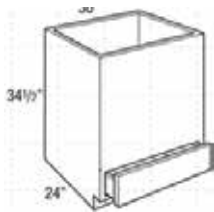

SPECS			
ITEM #	WIDTH	HEIGHT	DEPTH
BMW30	30	34 1/2	24

MH&SH: Drawer Height: 6 3/8" Opening: Width: 26 3/4" Height 20 1/2"

MC&CO&SS: Drawer Height: 9" Opening: Width: 27" Height 19 1/3"

Base End Angle Cabinet



ITEM #	WIDTH	SPECS	
		HEIGHT	DEPTH
BEA12	12	34 1/2	24

Base End Cabinet

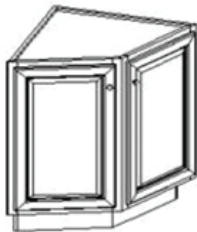

ITEM #	WIDTH	SPECS	
		HEIGHT	DEPTH
BEC24	24	34 1/2	24

Waste Basket Cabinet (Single and Double)

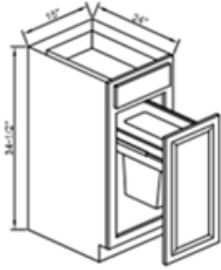

ITEM #	WIDTH	SPECS	
		HEIGHT	DEPTH
BWBK15-1	15	34 1/2	24
BWBK18-2	18	34 1/2	24

Utility Cabinet 84"



ITEM #	WIDTH	SPECS	
		HEIGHT	DEPTH
UC1584	15	84	24
UC1884	18	84	24
UC2484	24	84	24
UC3084	30	84	24

Utility Cabinet 90"



ITEM #	WIDTH	SPECS	
		HEIGHT	DEPTH
UC1590	15	90	24
UC1890	18	90	24
UC2490	24	90	24
UC3090	30	90	24

Utility Cabinet 93"



ITEM #	WIDTH	SPECS	
		HEIGHT	DEPTH
UC1593	15	93	24
UC1893	18	93	24
UC2493	24	93	24
UC3093	30	93	24

Utility Cabinet 96"

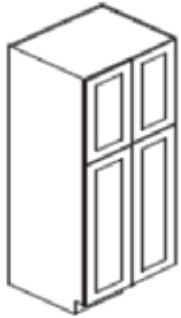

ITEM #	WIDTH	SPECS	
		HEIGHT	DEPTH
UC1596	15	96	24
UC1896	18	96	24
UC2496	24	96	24
UC3096	30	96	24

Oven Cabinet

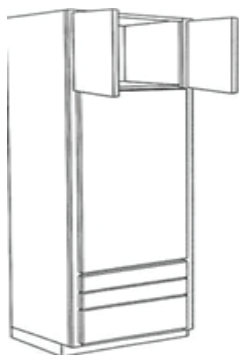

ITEM #	WIDTH	SPECS	
		HEIGHT	DEPTH
OC3384	33	84	24
OC3390	33	90	24
OC3393	33	93	24
OC3396	33	93	24

***Opening Height: 30" Drawer Height from top to bottom: OC3384: 4 ¾" 4 ¾" 14 1/2"**
OC3393: 4 ½" 4 ½" 14 ¼" Door Height: OC3384: 19 ½" OC3393: 28 ½"***

Desk Cabinet Drawer

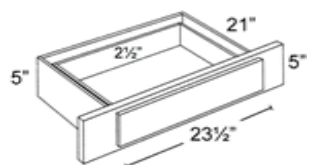

ITEM #	WIDTH	SPECS	
		HEIGHT	DEPTH
KD30	30		

Roll Out Trays

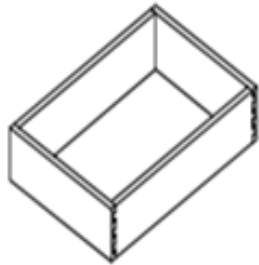

ITEM #	WIDTH	SPECS	
		HEIGHT	DEPTH
RT 15	1		
RT 18	1		
RT 21	2		
RT 24	2		
RT 27	2		
RT 30	3		
RT33	3		
RT 36	3		
Drawer Glides	1		

Base Fillers

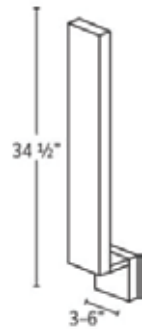

ITEM #	WIDTH	SPECS	
		HEIGHT	DEPTH
BF3	3	34 1/2	3/4
BF6	6	34 1/2	3/4

*Please note: Items with * are not in stock yet, coming soon

Wall Fillers



ITEM #	WIDTH	SPECS	
		HEIGHT	DEPTH
WF330	3	30	3/4
WF336	3	36	3/4
WF339	3	39	3/4
WF342	3	42	3/4
WF630	6	30	3/4
WF636	6	36	3/4
WF639	6	39	3/4
WF642	6	42	3/4

Tall Fillers



ITEM #	WIDTH	SPECS	
		HEIGHT	DEPTH
TF390	3	90	3/4
TF393	3	93	3/4
TF396	3	96	3/4
TF690	6	90	3/4
TF693	6	93	3/4
TF696	6	96	3/4

Dish Washer Panel

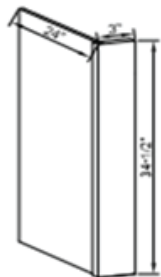

ITEM #	WIDTH	SPECS	
		HEIGHT	DEPTH
DWR3	3	34 1/2	3/4

Refrigerator End Panel



ITEM #	WIDTH	SPECS	
		HEIGHT	DEPTH
REP3084	30	84	3/4
REP3090	30	90	3/4
REP3093	30	93	3/4
REP3096	30	96	3/4

Finished Back Panel

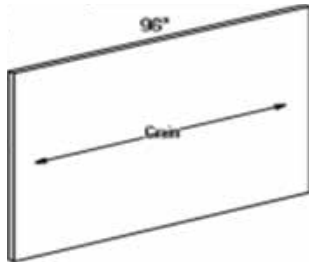

ITEM #	WIDTH	SPECS	
		HEIGHT	DEPTH
FBP4896 1/4	48	96	1/4
FBP4896 1/2	48	96	1/2

Finished Side Panel-Skin

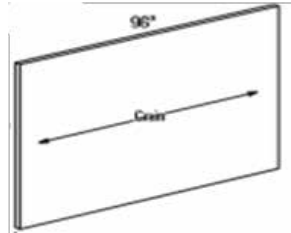

ITEM #	WIDTH	SPECS	
		HEIGHT	DEPTH
FBP-B	24	34.5	1/4
FBP-W	12	42	1/4

Toe Kick



ITEM #	WIDTH	SPECS	
		HEIGHT	DEPTH
TK8	96	4 1/2	3/8

Base Molding

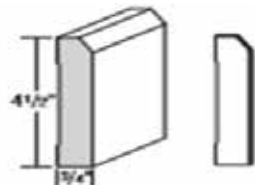

ITEM #	WIDTH	SPECS	
		HEIGHT	DEPTH
BM8	96	4 1/2	3/4

Scribe Molding

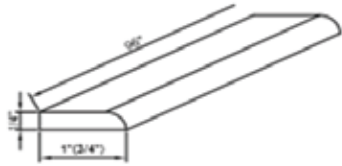

ITEM #	WIDTH	SPECS	
		HEIGHT	DEPTH
SM8	96	3/4	1/4

Quarter Round Molding

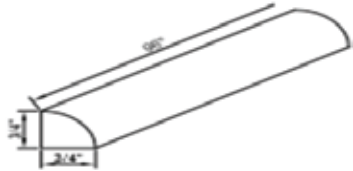

ITEM #	WIDTH	SPECS	
		HEIGHT	DEPTH
QM8	96	3/4	3/4

Outside Corner Molding

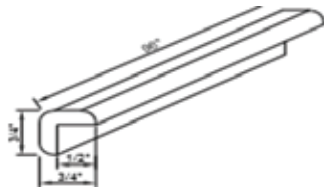

ITEM #	WIDTH	SPECS	
		HEIGHT	DEPTH
OCM8	96	3/4	3/4

Inside Corner Molding

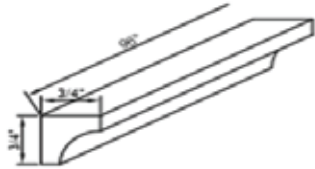

ITEM #	WIDTH	SPECS	
		HEIGHT	DEPTH
ICM8	96	3/4	3/4

Royal Crown Molding

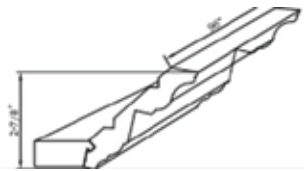

ITEM #	WIDTH	SPECS	
		HEIGHT	DEPTH
RCM4	96	5	

Large Cove Molding



ITEM #	WIDTH	SPECS	
		HEIGHT	DEPTH
LCM8	96	5	

Small Cove Molding



ITEM #	WIDTH	SPECS	
		HEIGHT	DEPTH
SCM8	96	3	

Quarter Round Molding

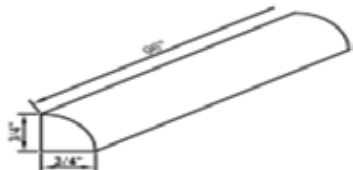

ITEM #	WIDTH	SPECS	
		HEIGHT	DEPTH
QM8	96	3/4	3/4

Light Rail Molding

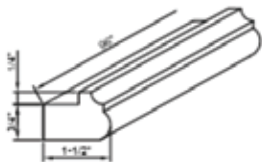

ITEM #	WIDTH	SPECS	
		HEIGHT	DEPTH
LRM8	96	1	1 1/2"

Valance

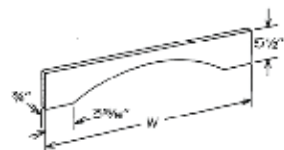

ITEM #	WIDTH	SPECS	
		HEIGHT	DEPTH
VAL36	36	5 1/2	3/4
VAL48	48	5 1/2	3/4
VAL54	54	5 1/2	3/4

Valance Recessed

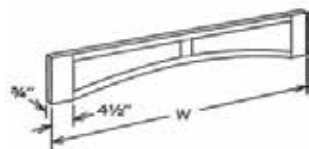

ITEM #	WIDTH	SPECS	
		HEIGHT	DEPTH
VAL-REC42	42	5 1/2	3/4
VAL-REC54	54	5 1/2	3/4

Floating Shelves

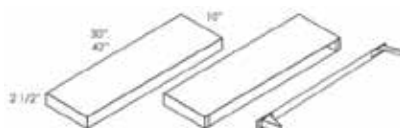

ITEM #	WIDTH	SPECS	
		HEIGHT	DEPTH
FLS30	30	2 1/2"	10"
FLS36	36	2 1/2"	10"
FLS42	42	2 1/2"	10"

Base Decorative Door

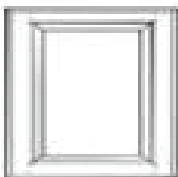

ITEM #	WIDTH	SPECS	
		HEIGHT	DEPTH
BDD24	23 3/4	30	3/4

Wall Decorative Door



ITEM #	WIDTH	SPECS	
		HEIGHT	DEPTH
WDD1230	11 3/4	30	3/4
WDD1236	11 3/4"	36	3 /4
WDD1239	11 3/4"	39	3/4
WDD1242	11 3/4	42	3/4

Glass Door Cabinet



ITEM #	WIDTH	SPECS	
		HEIGHT	DEPTH
GD1230	12	30	3/4
GD1236	12	36	3/4
GD1242	12	42	3/4
GD1530	15	30	3/4
GD1536	15	36	3/4
GD1542	15	42	3/4
GD1830	18	30	3/4
GD1836	18	36	3/4
GD1842	18	42	3/4
GD2430	24	30	3/4
GD2436	24	36	3/4
GD2442	24	42	3/4
GD3030	24	30	3/4
GD3036	30	36	3/4
GD3042	24	42	3/4
GD3630	24	30	3/4
GD3636	36	36	3/4
GD3642	24	42	3/4

Glass Door for Angle Wall Cabinet



ITEM #	WIDTH	SPECS	
		HEIGHT	DEPTH
GDC2430	24	30	3/4
GDC2436	24	36	¾
GDC2439	24	39	¾

Glass Door only



ITEM #	WIDTH	SPECS	
		HEIGHT	DEPTH
GD1230	12	30	3/4
GD1236	12	36	3/4
GD1239	12	39	3/4
GD1530	15	30	3/4
GD1536	15	36	3/4
GD1539	15	39	3/4
GD1830	18	30	3/4
GD1836	18	36	3/4
GD1839	18	39	3/4
GD2430	24	30	3/4
GD2436	24	36	3/4
GD2439	24	39	3/4
GD3030	30	30	3/4
GD3036	30	36	3/4
GD3039	30	39	3/4
GD3630	36	30	3/4
GD3636	36	36	3/4
GD3639	36	39	3/4

Vanity Sink Drawer

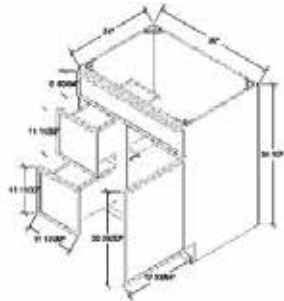

ITEM #	WIDTH	SPECS	
		HEIGHT	DEPTH
VSD30L	30"	34 ½"	21"
VSD30R	30"	34 ½"	21"

Vanity Sink Drawer

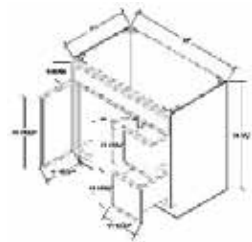

ITEM #	WIDTH	SPECS	
		HEIGHT	DEPTH
VSD36L	36"	34 ½"	21"
VSD36R	36"	34 ½"	21"

Glass Door Cabinet for Angle Wall Cabinet



ITEM #	WIDTH	SPECS	
		HEIGHT	DEPTH
GDC2430	24	30	3/4
GDC2436	24	36	¾
GDC2442	24	42	¾

Vanity Sink Base

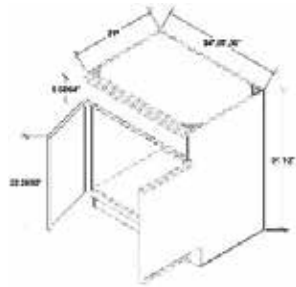

ITEM #	WIDTH	SPECS	
		HEIGHT	DEPTH
VSB24	24"	34 ½"	21"
VSB30	30"	34 ½"	21"
VSB36	36"	34 ½"	21"

Vanity Drawer Base

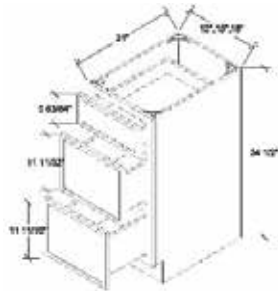

ITEM #	WIDTH	SPECS	
		HEIGHT	DEPTH
VDB12	24	34 ½"	21
VDB15	30	34 ½"	21
VDB18	30	34 ½"	21

Touch-Up Kit





Post

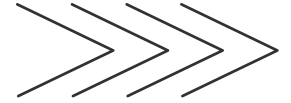

Item#	WIDTH	SPECS	
		Height	DEPTH
SP36	4 ½"	34 1/2"	4 ½"

OUR COMMITMENT TO SUSTAINABILITY & ENVIRONMENTAL RESPONSIBILITY



 FERMA CABINETRY provides high-quality kitchen cabinetry while upholding a strong commitment to sustainability and environmental responsibility. As a brand of FERMA FLOORING built on over 23 years of excellence in the flooring industry, FERMA CABINETRY follows eco-conscious practices to ensure that its products contribute to a greener, healthier planet.

Eco-Friendly Materials – FERMA CABINETRY will carefully select sustainable wood sources and responsibly harvested materials to reduce environmental impact while maintaining high-quality craftsmanship.

Low VOC Finishes – FERMA CABINETRY's cabinetry will be finished with low-VOC (Volatile Organic Compounds) coatings to promote better indoor air quality and create a healthier home environment.

Sustainable Manufacturing Practices – FERMA CABINETRY will implement energy-efficient and waste-reducing manufacturing processes to minimize our carbon footprint.

Durable & Long-Lasting Design – By creating cabinets that are built to last, FERMA CABINETRY will help to reduce waste and encourage long-term sustainability through durable, high-quality craftsmanship.

Eco-Conscious Packaging – FERMA CABINETRY will prioritize using recyclable and eco-friendly packaging materials to minimize waste and promote responsible consumption.

FERMA CABINETRY is committed to combining style, functionality, and sustainability to help homeowners create beautiful kitchens while making environmentally responsible choices. With its dedication to green initiatives, FERMA CABINETRY aims to contribute to a better future for our customers and the planet.

FERMA CABINETRY's manufacturer has been assessed and certified as meeting the requirements of ISO 9001:2015. Additionally, all plywood or medium-density fiberboards used for FERMA CABINETRY's products comply with USEPA, CARB, and CARB II standards.

LIMITED LIABILITY WARRANTY

This warranty is effective on all cabinets under the brand name of FERMA CABINETRY that are distributed by FERMA CABINETRY in the United States. This warranty is subject to all limitations, exclusions, disclaimers and procedures set forth herein, and it is for residential use only, and does not cover or apply for commercial applications or rental multi-family dwellings.

FERMA CABINETRY, warrants its cabinetry ("the Products or the Cabinets") to be free of manufacturer defects for five (5) years from the date of purchase by the original purchaser if the products are in stained finishes, but products with painted finishes are limited to two (2) year warranty, or as long as the original purchasing consumer owns the home, whichever is less, against avoidable and unnatural defects in material and workmanship under normal use.

This limited warranty applies to domestic use only, is non-transferable, and proof of purchase is required.

This warranty does not cover the products that have been misused, mishandled, abused, improperly stored or installed, modified or subject to excesses of moisture or extreme temperatures, accidents, negligence, on-site alterations, improper storage, defective installation, or normal wear and tear. The products must be used exclusively for their intended purpose to be covered by this warranty. This warranty shall become void if the products are modified in any way, improperly installed or damaged prior to or during installation, or installed or utilized in other than normal residential applications.

This warranty does not include or not cover the cost of installation, removal, subsequent damage or transportation of the defective product, regardless of whether work was performed by a contractor, service company, or homeowner or any other end user.

This warranty does not apply to any other products used in conjunction with the products (cabinetry), such as, but not limited to flooring, countertops, appliances, or plumbing fixtures.

The obligation of FERMA CABINETRY, under this warranty shall be only limited to the repair or exchange of any part or parts that the products deem prove defective under normal use and service within the warranty period. If a defect does occur within the terms and conditions of this warranty, such defective part will be repaired or replaced by FERMA CABINETRY at its sole discretion. FERMA CABINETRY will not provide or pay for the cost of removal of defective products, transportation of defective, repaired or replaced products or installation of repaired or replaced products. FERMA CABINETRY will not be responsible for any shipping damage to the defective, replaced or repaired product. The product line and specifications of the products may periodically be changed or discontinued. If defective items have been discontinued or is not available at the time, FERMA CABINETRY reserves the right to replace the item with the most similar item available in its inventory at that time.

Some replacement parts are subject to availability, and they may differ from those originally supplied. FERMA CABINETRY cannot guarantee that the finish of any replacement will exactly match the finish and appearance of the defective item due to the natural aging process of wood and finishes of the cabinets. Accordingly, FERMA CABINETRY will NOT be held responsible for replacing products that may not exactly match installed products.

The cabinets are constructed from several pieces of solid wood and wood veneers on plywood. Differences in grain pattern and color should be expected. Wood characteristics naturally occurring such as variations in color, grain, mineral streaks and knots, are not considered defects. Color variations and color softening in cabinets are a natural occurrence due to wood species, age, character of cabinets, and exposure to UV light and sunlight. For these reasons, new and/or replacement cabinets may not match display samples and/or existing cabinets. Therefore, such variations and changes are NOT considered defects.

This warranty applies only to defects and does not apply to the yellowing and aging of any wood product. The cabinets are wood products. Extreme conditions will cause any wood product to respond adversely (high/low humidity, temperature, etc.) and this warranty does not apply to cabinetry exposed to extreme conditions. Mitered door joints are more likely to react to conditions of their environment. Gaps that may develop in door joints due to conditions of their environment are not subject to replacement under this warranty. Painted finishes reacting differently than stained finish with normal wood movement and climatic conditions, may result in breaks in finish, recesses, and joint and panel lines. These features are considered normal occurrences and not covered under this warranty.

Wood by nature will undergo expansion and contraction movements year after year as it compensates and adjusts to ever changing atmospheric humidity and temperature conditions. It is common for center panels on doors to shrink, expand or move during these transitions. Typically, the panel will return to its normal position within a year once it has adjusted to seasonal changes. It is for these same reasons that it is common for doors to warp during these periods. Therefore, doors that are warped in either direction not exceeding one-quarter inch (1/4") do not exceed normal material expectation and they are not covered under the terms of this warranty.

Warranty claims are only filed with FERMA CABINETRY by dealer or distributors from whom the products were purchased. To submit a warranty claim, the original purchaser must contact FERMA CABINETRY's dealer or distributor where the product was purchased. The independent dealer or distributor will obtain the information necessary to make a claim decision and forward such information in writing to FERMA CABINETRY for action on the claim.

This writing is the complete and exclusive statement of the express warranties provided herein and is in lieu of all other express and/or statutory warranties by the manufacturer, to the extent provided by law. There are no implied warranties extending beyond the terms of this warranty. FERMA CABINETRY shall not be liable for any incidental or consequential costs, expenses or damages.

KITCHEN CABINETS MAINTENANCE GUIDELINES

Thank you for choosing FERMA CABINETRY for your kitchen! FERMA CABINETRY's solid wood framed cabinets are built to last, but proper maintenance will ensure they remain beautiful and functional for years to come. Follow these guidelines to care for your cabinets effectively.

Daily Cleaning & Care

- **Dust Regularly:** Use soft and dry microfiber cloth or slightly damp cloth to remove dust.
- **Wipe Spills Immediately:** Water, oil, and food spills should be wiped off promptly to prevent stains and damage to the wood.
- **Mild Soap Cleaning:** For routine cleaning, use a damp cloth with mild dish soap. Wipe dry with soft cloth immediately.
- **Avoid Abrasives:** Do not use harsh chemicals, scouring pads, or abrasive cleaners as they can scratch or damage the finish.

Deep Cleaning & Stain Removal

- **Grease Buildup:** Use a mixture of warm water and mild dish soap to remove grease from cabinet surfaces. Rinse with a damp cloth and dry immediately.
- **Stubborn Stains:** For tougher stains, use a solution of equal parts vinegar and water. Apply lightly, then wipe dry. Avoid excessive moisture.
- **Glass Panels:** Use a glass cleaner applied to a soft cloth (not directly on the glass) to clean cabinet glass inserts.

Wood Protection & Preservation

- **Use Furniture Polish Sparingly:** Apply a high-quality furniture polish occasionally to enhance the cabinet's finish. Avoid wax-based polishes, as they can build up and dull the surface.
- **Protect from Heat & Moisture:** Keep cabinets away from excessive moisture, steam, and direct heat sources. Use range hoods when cooking to reduce humidity exposure.

Hardware Maintenance

- **Handles & Knobs:** Clean cabinet handles and knobs regularly with mild soap and water to prevent dirt buildup. Dry thoroughly to avoid corrosion.
- **Hinges & Drawer Slides:** Lubricate hinges and slides with a small amount of silicone spray if they become stiff or noisy.

Preventative Measures

- **Avoid Hanging Wet Towels:** Do not hang wet towels or dishcloths on cabinet doors as moisture can damage the wood and finish.
- **Use Cabinet Liners:** Place liners inside cabinets to protect against spills and scratches, especially for heavy cookware or pantry items.
- **Protect Against Sunlight:** Prolonged exposure to direct sunlight can cause discoloration. Use window coverings to reduce UV exposure.

Seasonal Care & Inspection

- **Check for Loose Hinges & Knobs:** Periodically inspect and tighten any loose hardware to prevent wear and tear.
- **Monitor Humidity Levels:** Keep indoor humidity between 35% and 50% to prevent wood expansion or contraction, which can cause warping or cracking.

By following these maintenance tips, your FERMA CABINETRY kitchen cabinets will remain in excellent condition for years to come. If you have any questions or need further assistance, please contact our customer support team.

Enjoy your beautiful kitchen!

FERMA CABINETRY SAMPLES DISPLAY PROGRAM



Display Rack + Sample Doors

Size: 17"W x 67"H x 31"D

Total of 5-8 samples doors: 15" W x 30"H

\$199.00

50% off on the display order, the payment for your display order will be rebated on your first order.





Cabinet Set Display
Size: 10' x 10', 8' x 8', or 6' x 6' or Others
50% off on the display order, the payment
for your display order will be rebated on
your first 3 orders (1/3 rebated on each order).

NEW ACCOUNT APPLICATION FORM

COMPANY NAME _____ WEBSITE _____

BILLING ADDRESS _____ ATTENTION _____ POSITION _____ CELL _____

CITY _____ STATE _____ ZIP _____ TELEPHONE _____ FAX _____

EMAIL ADDRESS _____ ATTENTION _____

SHIP TO ADDRESS _____

_____ STATE _____ ZIP _____ PHONE: _____

TYPE OF BUSINESS _____ CORPORATION / _____ LLC. / _____ PROPRIETORSHIP _____

RETAIL STORE _____ CONTRACTOR _____

SALES TAX EXEMPT ID _____ FEDERAL TAX ID _____ STATE _____ NAME OF THE SALES REP _____

Accounts -Payable Contact: _____ Email: _____

CORPORATE OFFICERS / OWNERS NAMES:

_____ TITLE _____

_____ TITLE _____

_____ TITLE _____

DATE COMPANY STARTED _____ NUMBER OF EMPLOYEES _____ BUILDING OWNED OR RENTED _____

CREDIT REFERENCES

SUPPLIER NAME ADDRESS TELEPHONE FAX

1. _____
2. _____
3. _____

BANK REFERENCES

BANK NAME _____ TELEPHONE _____

ACCOUNT # _____ BANK OFFICER NAME _____

The Company gives permission to the above-referenced bank to release information about the Company to the FERMA FLOORING Company, or FERMA Cabinetry. The above company agrees to pay to FERMA FLOORING or FERMA CABINETRY, all costs and expenses incurred in collecting outstanding amounts due and payable (i.e. amounts unpaid from insufficient funds returned checks) , including all attorney fees and court costs, and agrees that it will pay a finance charge of 2% per month on all outstanding amounts due and payable.

Signed: _____ Title: _____

Print Name: _____ Date: _____

ORDER FORM (Manhattan or SoHo)

Account Name		Ship to (if different)
Name:	Order Date:	Address:
Ordered by:	PO#	
Phone:	S/M:	City, State, Zip:
Fax:		
Email:		Contact:
		Cell Phone:
Address:		
City, State, Zip:		

<u>PLEASE MARK WITH "X"</u>					
Manhattan		Assembled		Delivery	
SoHo		Unassembled		Pick Up	
				Job Site Delivery address:	

WALL CABINET											
Item	QTY	Hinge (R/L)	Item	QTY	Hinge (R/L)	Item	QTY	Hinge (R/L)	Item	QTY	Hinge (R/L)
W0939			W1230			W3024			WDC2430		
W1239			W1530			W3324			WDC2436		
W1539			W1830			W3624			WDC2439		
W1839			W2130			W362424			WDC273915		
W2139			W2430			W2421			WEC1230		
W2439			W2730			W3021			WEC1236		
W2739			W3030			W302124			WEC1239		
W3039			W3330			W3621			WES0630		
W3339			W3630			W362124			WES0636		
W3639			W2415			W2418			WES0639		
W0936			W3015			W3018			WOS3030		
W1236			W301524			W301824			WOS3036		
W1536			W3315			W331824			WOS3039		
W1836			W331524			W3321			MS3018		
W2136			W3615			W332124			WR3018		
W2436			W361524			W3618			WX1818		
W2736			W3012			W361824			WO3006		
W3036			W301224			BLW27/3030			WD1818		
W3336			W3312			BLW27/3036			WER2430		
W3636			W3612			BLW27/3039			WER2436		

ORDER FORM (Manhattan or SoHo)

W0930			W361224			WDC273615			WER2439		
			W2424								

BASE CABINETS								
Item	QTY	Hinge (R/L)	Item	QTY	Hinge (R/L)	Item	QTY	Hinge (R/L)
B09			DB18-3			FSB33		
B12			DB21-3			FSB36		
B15			DB24-3			CSB36		
B18			DB27-3			BCB36/39		
B21			DB30-3			BCB42/45		
B24			DB33-3 (SoHo only)			LS33		
B27			DB36-3			LS36		
B30			SB24			SP09		
B33			SB27			BMW30		
B36			SB30			BEA12		
DB12-3			SB33			BEC24		
DB15-3			SB36			BWBK15-1		
			FSB30			BWBK18-2		

UTILITY CABINETS AND OVEN CABINETS					
Item	QTY	Hinge(R/L)	Item	QTY	Hinge(R/L)
UC1584			UC1593		
UC1884			UC1893		
UC2484			UC2493		
UC3084			UC3093		
UC1590			OC3384		
UC1890			OC3390		
UC2490			OC3393		
UC3090			KD30		

FILLERS AND PANELS			
Item	QTY	Item	QTY
BF3		TF693	
BF6		DWR3	
WF330		REP3084	
WF336		REP3093	
WF339		FBP4896	
WF630			
WF636			

ORDER FORM (Manhattan or SoHo)

MOLDINGS AND ACCESSORIES							
Item	QTY	Item	QTY	Item	QTY	Item	QTY
TK8		VAL-REC42		Touch up Kit		GD3036	
BM8		VAL-REC54		GD1230		GD3039	
SM8		BDD24		GD1236		GD3630	
QM8		WDD1230		GD1239		GD3636	
OCM8		WDD1236		GD1530		GD3639	
ICM8		WDD1239		GD1536		GDC2430	
RCM8		RT15		GD1539		GDC2436	
CCM8		RT18		GD1830		GDC2439	
SCM		RT21		GD1836		FLS24	
LRM		RT24		GD1839		FLS30	
VAL36		RT27		GD2430			
VAL48		RT30		GD2436			
VAL54		RT33		GD2439			
		RT36		GD3030			

ORDER FORM (Mastic, Cortado or Sandy Shore)

Account Name		Ship to (if different)
Name:	Order Date:	Address:
Ordered by:	PO#	
Phone:	S/M:	City, State, Zip:
Fax:		
Email:		Contact:
		Cell Phone:
Address:		
City, State, Zip:		

PLEASE MARK WITH "X"					
Mastic		Assembled		Delivery	
Cortado		Unassembled		Pick Up	
Sandy Shore				Job Site Delivery address:	

MOLDINGS AND ACCESSORIES							
Item	QTY	Item	QTY	Item	QTY	Item	QTY
TK8		LCM		BDD24		RT24	
BM8		SCM		WDD1230		RT27	
SM8		LRM		WDD1236		RT30	
QM8		VAL36		WDD1242		RT36	
OCM8		VAL54		RT15		Touch up Kit	
ICM		VAL-REC42		RT18			
RCM		VAL-REC54		RT21			

GLASS DOOR CABINET							
Item	QTY	Item	QTY	Item	QTY	Item	QTY
GD1230		GD1542		GD2436		GD3630	
GD1236		GD1830		GD2442		GD3636	
GD1242		GD1836		GD3030		GD3642	
GD1530		GD1842		GD3036			
GD1536		GD2430		GD3042			

GLASS DOOR CABINET FOR ANGLE WALL CABINET			
Item	QTY	ITEM	QTY
GDC2430		GDC2436	
GDC2442			